

# A30 Chiverton to Carland Cross TR010026

## 2.4(C) WORKS PLANS

Planning Act 2008

APFP Regulation 5(2)(j)  
Infrastructure Planning (Applications: Prescribed  
Forms and Procedure) Regulations 2009

Volume 2

April 2019



## **Contents**

1. WORKS PLANS KEY PLAN
2. WORKS PLANS SHEET 1 OF 8
3. WORKS PLANS SHEET 2 OF 8
4. WORKS PLANS SHEET 3 OF 8
5. WORKS PLANS SHEET 4 OF 8
6. WORKS PLANS SHEET 5 OF 8
7. WORKS PLANS SHEET 6 OF 8
8. WORKS PLANS SHEET 7 OF 8
9. WORKS PLANS SHEET 8 OF 8

DO NOT SCALE

0 10 100  
Millimetres

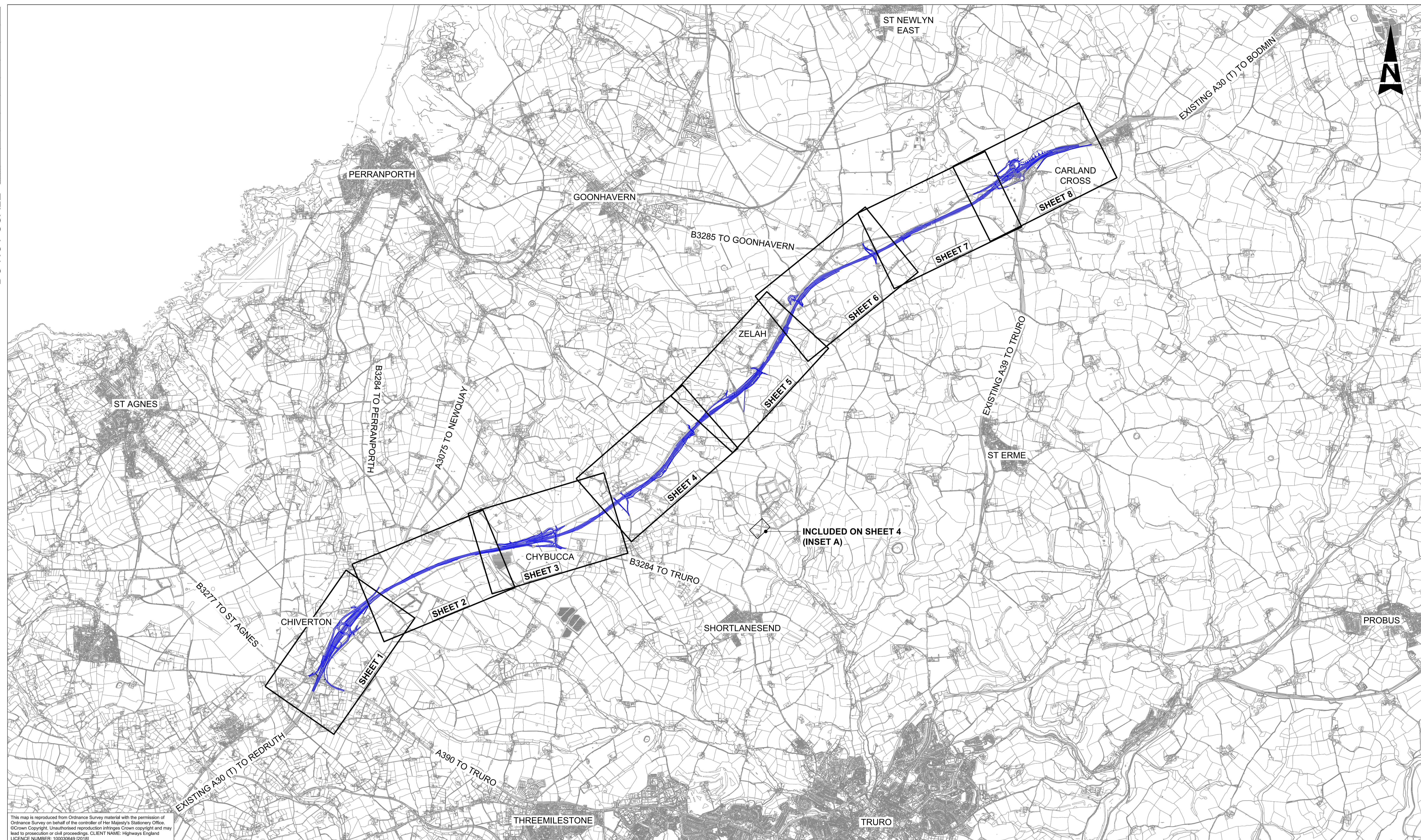

This map is reproduced from Ordnance Survey material with the permission of Ordnance Survey on behalf of the controller of Her Majesty's Stationery Office. © Crown Copyright. Unauthorised reproduction infringes Crown copyright and may lead to prosecution or civil proceedings. CLIENT NAME: Highways England LICENCE NUMBER: 100030649 (2018)

GENERAL NOTES:  
1. ALL DIMENSIONS ARE IN METRES UNLESS NOTED OTHERWISE.  
2. ONLY WRITTEN DIMENSIONS SHALL BE USED, DO NOT SCALE.  
LEGEND:  
 THE SCHEME (SHOWN FOR ILLUSTRATIVE PURPOSES)

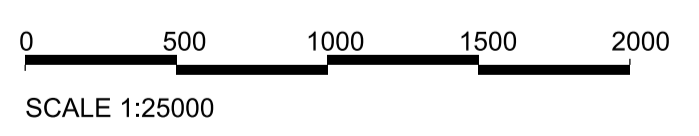

P02	04/07/18	ISSUED FOR COMMENT	RC	RC	RC	RC	
P03	22/08/18	DCO ISSUE	AJ	LP	RC	SW	
P04	22/08/18	DCO ISSUE	AJ	LP	RC	SW	
C01	22/08/18	DCO ISSUE	AJ	LP	RC	SW	
P05	19/12/18	VERSION A	HJ	RC	MB	DG	
P06	19/12/18	P06	HJ	RC	MB	DG	
C02	19/12/18	VERSION A	HJ	RC	MB	DG	
P07	17/04/19	VERSION C	HJ	LP	RC	RC	
P08	17/04/19	VERSION C	HJ	LP	RC	SW	
C03	17/04/19	VERSION C	HJ	LP	RC	SW	
Rev.	Date	Description	By	Chk'd	App'd	Auth'd	

Suitability: A3  
Drawing Status: STAGE COMPLETED

Client:

Project Title <b>A30 CHIVERTON TO CARLAND CROSS</b>					
Drawing Title <b>WORKS PLANS APFP REGULATION 5(2)(J) KEY PLAN</b>					
Scale 1:25000	By HJ	Checked LP	Approved RC	Authorised SW	
Original Size A1	Date 17/04/19	Date 17/04/19	Date 17/04/19	Date 17/04/19	Revision C03
Drawing Number HE PIN HA551502 - SW	Originator ARP	Volume LSI -DR - ZL -000400			
Location	Type	Role	Number		

DO NOT SCALE

Millimetres

0 10 100

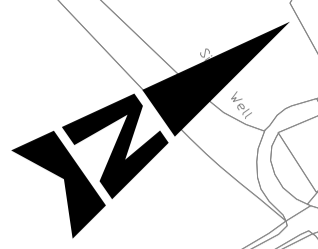
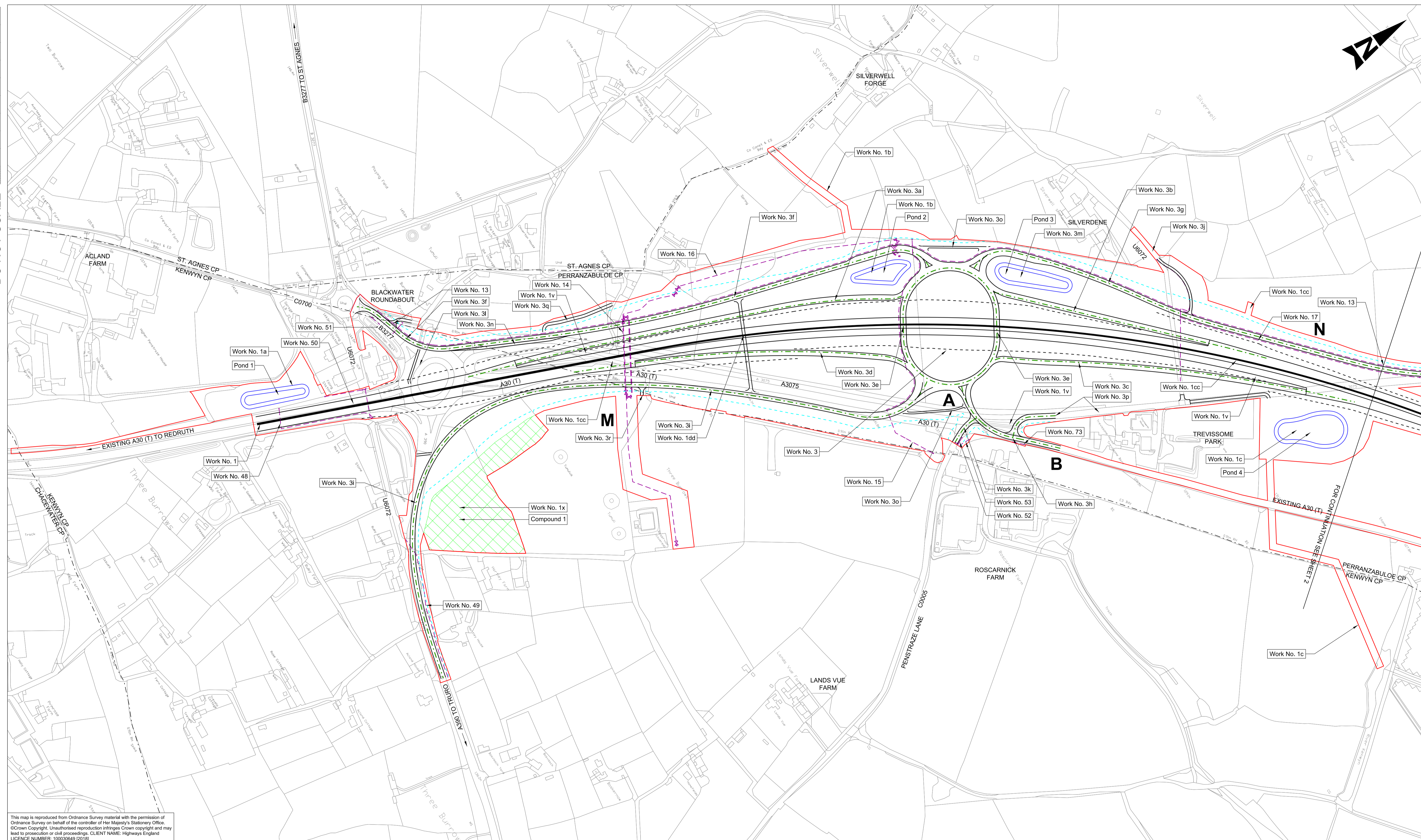

This map is reproduced from Ordnance Survey material with the permission of Ordnance Survey on behalf of the controller of Her Majesty's Stationery Office. © Crown Copyright. Unauthorised reproduction infringes Crown copyright and may lead to prosecution or civil proceedings. CLIENT NAME: Highways England LICENCE NUMBER: 100030649 (2018)

- GENERAL NOTES:**
- ALL DIMENSIONS ARE IN METRES UNLESS NOTED OTHERWISE.
  - ONLY WRITTEN DIMENSIONS SHALL BE USED, DO NOT SCALE.
  - THESE PLANS SHOULD BE READ IN CONJUNCTION WITH OTHER PLANS AND APPLICATION DOCUMENTS IN PARTICULAR SCHEDULE 3 OF THE DEVELOPMENT CONSENT ORDER.
- LEGEND:**
- DEVELOPMENT CONSENT ORDER BOUNDARY
  - A30 MAINLINE CENTRELINE
  - EXTENT OF CARRIAGEWAY (INCLUDING 0.5M LATERAL DEVIATION)
  - A30 MAINLINE EARTHWORKS (INCLUDING 1.75M LATERAL DEVIATION)
  - SIDE ROAD, JUNCTION AND SLIP ROAD CENTRELINE
  - SIDE ROAD EARTHWORKS (INCLUDING 1.75M LATERAL DEVIATION)
  - UTILITY DIVERSION WORK CENTRELINE
  - ATTENUATION POND BOUNDARY
  - PARISH BOUNDARY

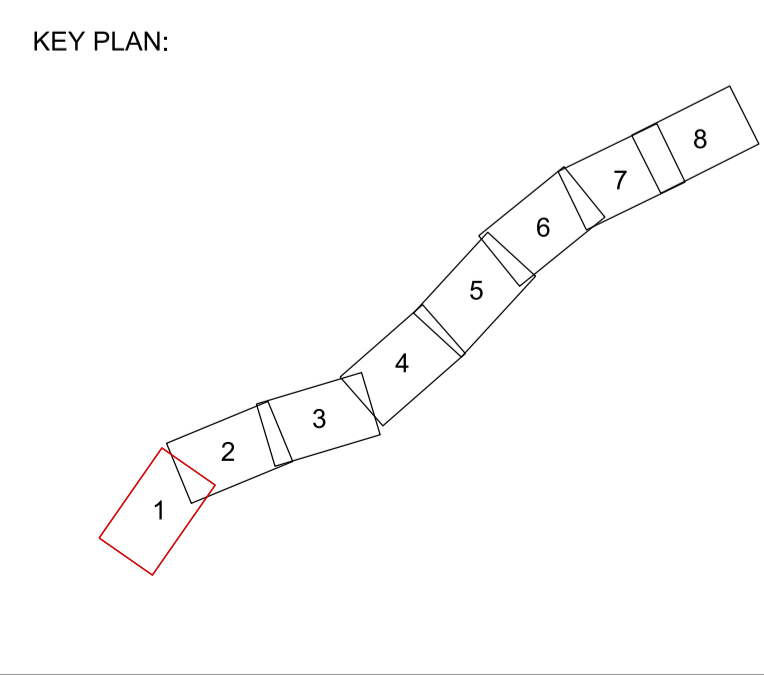
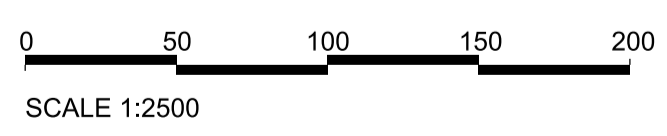

Rev.	Date	Description	By	Chk'd	App'd	Auth'd
C02	19/12/18	VERSION A	RC	RC	MB	DG
P17	07/01/19	VERSION A	HJ	MB	MB	—
P18	07/01/19	VERSION A	HJ	MB	MB	SW
C03	07/01/19	VERSION A	HJ	MB	MB	SW
P19	15/03/19	VERSION B	HJ	LP	RC	—
P20	15/03/19	P20	HJ	LP	RC	SW
C04	15/03/19	VERSION B	HJ	LP	RC	SW
P21	17/04/19	VERSION C	HJ	LP	RC	RC
P22	17/04/19	VERSION C	HJ	LP	RC	SW
C05	17/04/19	VERSION C	HJ	LP	RC	SW

Suitability: **A3** | Drawing Status: **STAGE COMPLETED**

Client:

Project Title: <b>A30 CHIVERTON TO CARLAND CROSS</b>					
Drawing Title: <b>WORKS PLANS APFP REGULATION 5(2)(J) SHEET 1 OF 8</b>					
Scale: 1:2500	By: HJ	Checked: LP	Approved: RC	Authorised: SW	
Original Size: A1	Date: 17/04/19	Date: 17/04/19	Date: 17/04/19	Date: 17/04/19	
Drawing Number: HA551502 - SW	Originator: ARP	Volume: LSI	Number: -DR-ZL-000401	Revision: C05	
Location	Type	Role	Number		

DO NOT SCALE

Millimetres

0 10

100

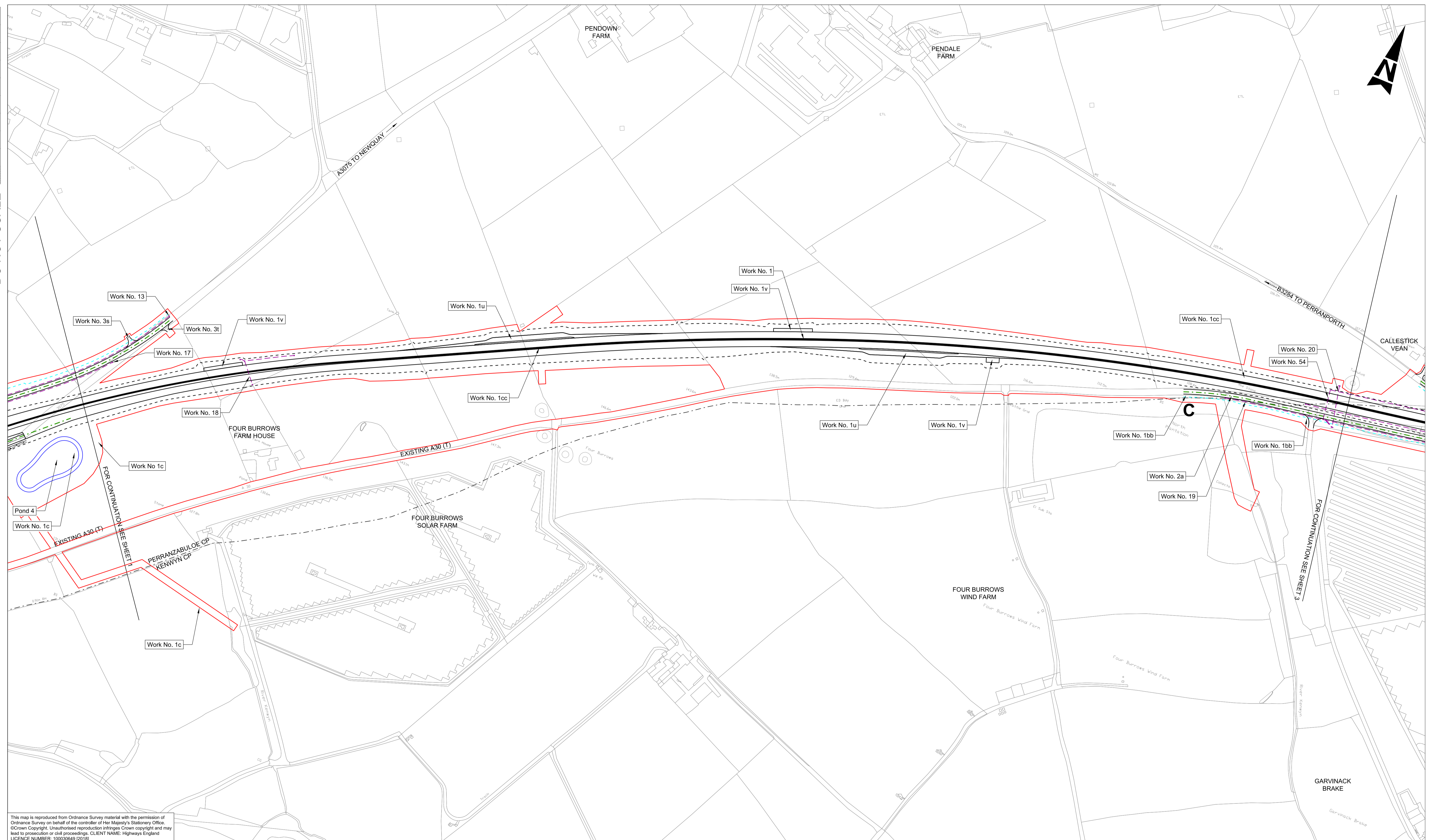

This map is reproduced from Ordnance Survey material with the permission of Ordnance Survey on behalf of the controller of Her Majesty's Stationery Office. © Crown Copyright. Unauthorised reproduction infringes Crown copyright and may lead to prosecution or civil proceedings. CLIENT NAME: Highways England LICENCE NUMBER: 100030649 (2018)

GENERAL NOTES:  
 1. ALL DIMENSIONS ARE IN METRES UNLESS NOTED OTHERWISE.  
 2. ONLY WRITTEN DIMENSIONS SHALL BE USED, DO NOT SCALE.  
 3. THESE PLANS SHOULD BE READ IN CONJUNCTION WITH OTHER PLANS AND APPLICATION DOCUMENTS IN PARTICULAR SCHEDULE 3 OF THE DEVELOPMENT CONSENT ORDER.

LEGEND:  
 - - - - - DEVELOPMENT CONSENT ORDER BOUNDARY  
 ——— A30 MAINLINE CENTRELINE  
 ——— EXTENT OF CARRIAGEWAY (INCLUDING 0.5M LATERAL DEVIATION)  
 - - - - - A30 MAINLINE EARTHWORKS (INCLUDING 1.75M LATERAL DEVIATION)  
 - - - - - SIDE ROAD, JUNCTION AND SLIP ROAD CENTRELINE  
 - - - - - SIDE ROAD EARTHWORKS (INCLUDING 1.75M LATERAL DEVIATION)  
 - - - - - UTILITY DIVERSION WORK CENTRELINE  
 - - - - - ATTENUATION POND BOUNDARY  
 - - - - - PARISH BOUNDARY

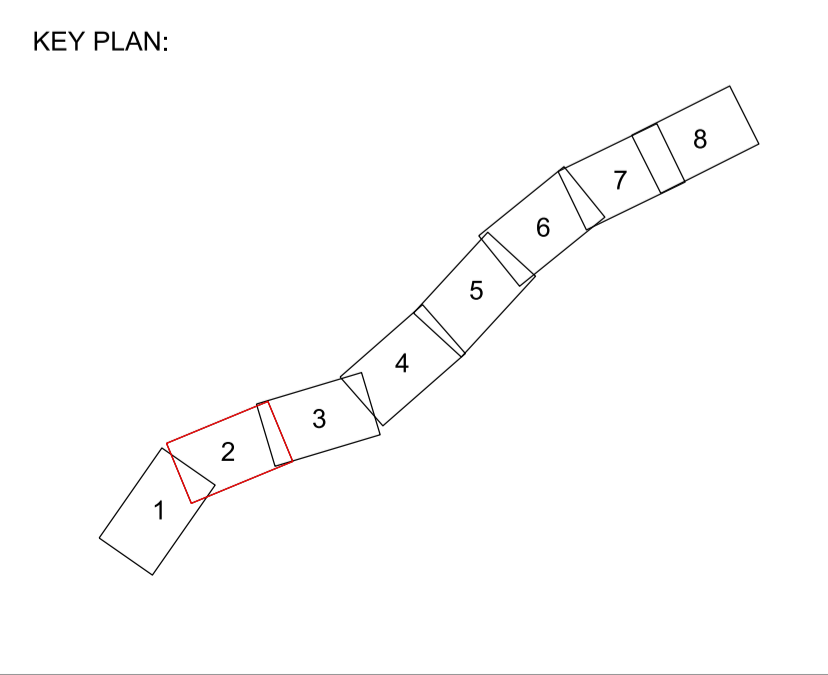
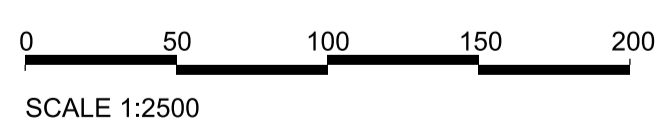

Rev.	Date	Description	By	Chk'd	App'd	Auth'd
P10	21/08/18	DCO ISSUE	LP	LP	RC	—
P11	21/08/18	DCO ISSUE	HJ	LP	RC	—
P12	22/08/18	DCO ISSUE	HJ	LP	RC	SW
C01	22/08/18	DCO ISSUE	HJ	LP	RC	SW
P13	19/12/18	VERSION A	HJ	RC	MB	—
P14	19/12/18	P14	HJ	RC	MB	DG
C02	19/12/18	VERSION A	HJ	RC	MB	DG
P15	17/04/19	VERSION C	HJ	LP	RC	RC
P16	17/04/19	VERSION C	HJ	LP	RC	SW
C03	17/04/19	VERSION C	HJ	LP	RC	SW

Suitability	A3	Drawing Status	STAGE COMPLETED
Client			

Project Title						A30 CHIVERTON TO CARLAND CROSS					
Drawing Title						WORKS PLANS APFP REGULATION 5(2)(J) SHEET 2 OF 8					
Scale	1:2500	By	HJ	Checked	LP	Approved	RC	Authorised	SW		
Original Size	A1	Date	17/04/19	Date	17/04/19	Date	17/04/19	Date	17/04/19		
Drawing Number	HA551502 - SW	Originator	ARP	Volume	LSI	-DR -ZL -000402		C03			
Location		Type		Role		Number					

DO NOT SCALE

Millimetres

0 10

100

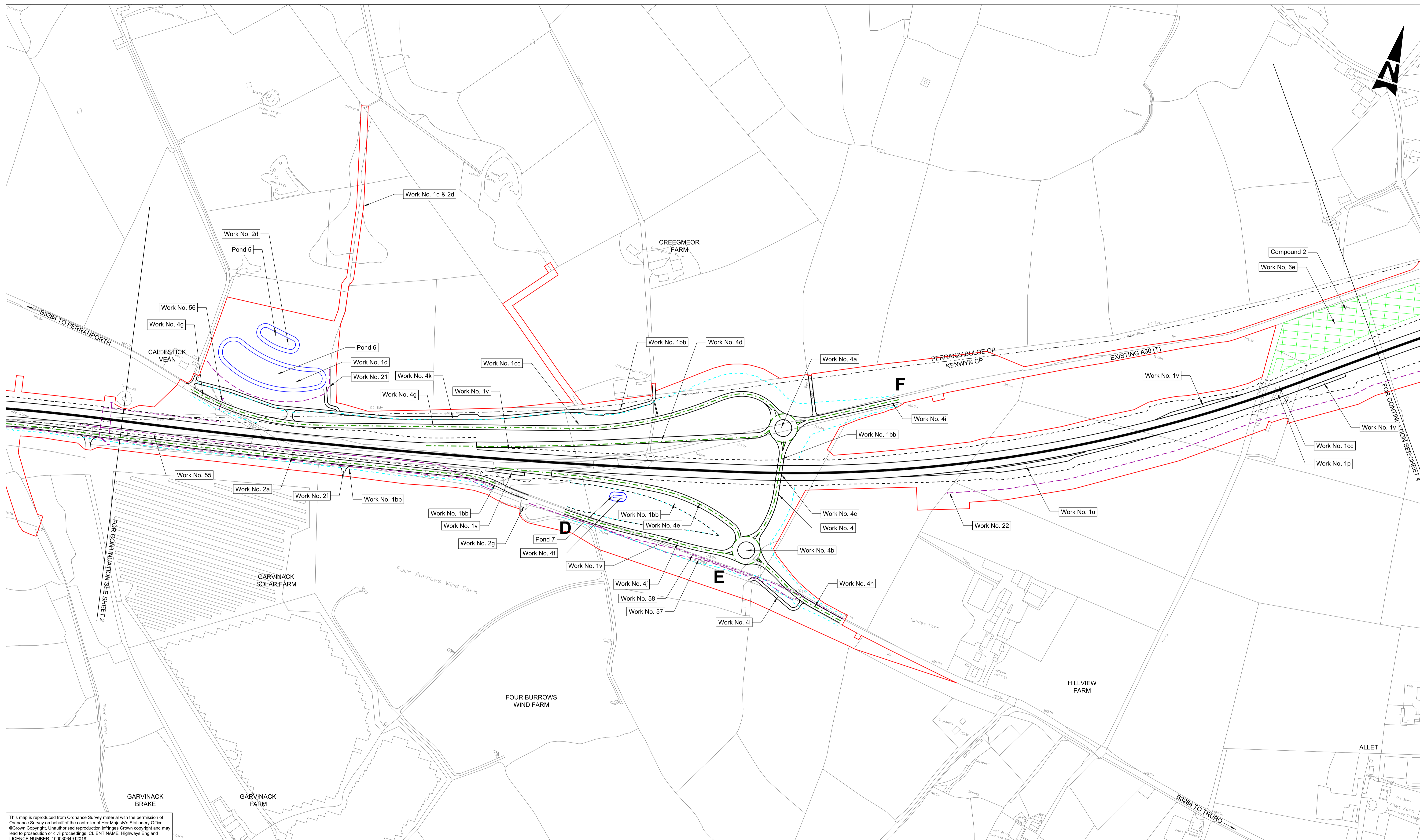

This map is reproduced from Ordnance Survey material with the permission of Ordnance Survey on behalf of the controller of Her Majesty's Stationery Office. © Crown Copyright. Unauthorised reproduction infringes Crown copyright and may lead to prosecution or civil proceedings. CLIENT NAME: Highways England LICENCE NUMBER: 100030649 (2018)

GENERAL NOTES:  
 1. ALL DIMENSIONS ARE IN METRES UNLESS NOTED OTHERWISE.  
 2. ONLY WRITTEN DIMENSIONS SHALL BE USED, DO NOT SCALE.  
 3. THESE PLANS SHOULD BE READ IN CONJUNCTION WITH OTHER PLANS AND APPLICATION DOCUMENTS IN PARTICULAR SCHEDULE 3 OF THE DEVELOPMENT CONSENT ORDER.

LEGEND:  
 - - - - - DEVELOPMENT CONSENT ORDER BOUNDARY  
 ——— A30 MAINLINE CENTRELINE  
 ——— EXTENT OF CARRIAGEWAY (INCLUDING 0.5M LATERAL DEVIATION)  
 - - - - - A30 MAINLINE EARTHWORKS (INCLUDING 1.75M LATERAL DEVIATION)  
 - - - - - SIDE ROAD, JUNCTION AND SLIP ROAD CENTRELINE  
 - - - - - SIDE ROAD EARTHWORKS (INCLUDING 1.75M LATERAL DEVIATION)  
 - - - - - UTILITY DIVERSION WORK CENTRELINE  
 - - - - - ATTENUATION POND BOUNDARY  
 - - - - - PARISH BOUNDARY

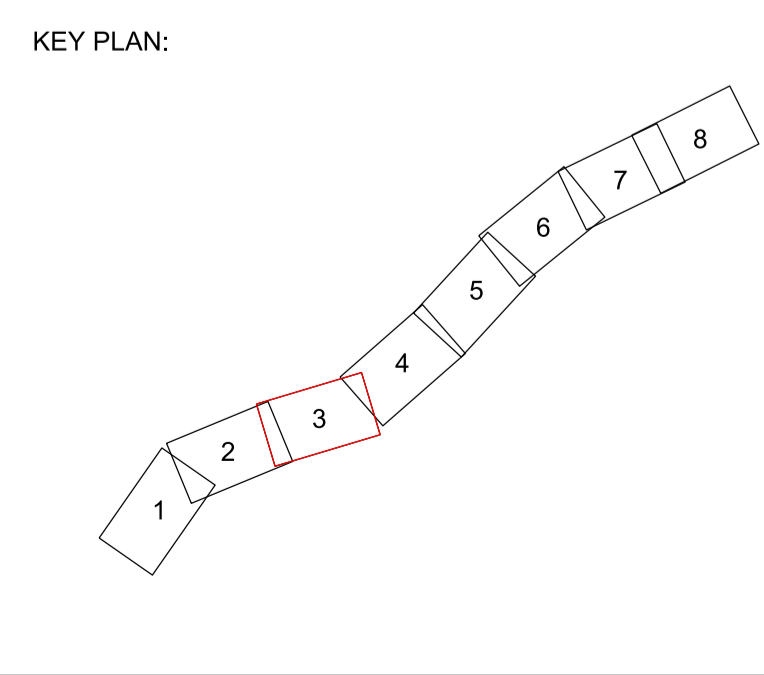
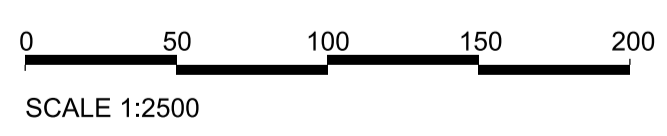

Rev.	Date	Description	By	Chk'd	App'd	Auth'd
C01	22/08/18	DCO ISSUE	LP	LP	RC	SW
P13	19/12/18	VERSION A	HJ	RC	MB	—
P14	19/12/18	VERSION A	HJ	RC	MB	DG
C02	19/12/18	VERSION A	HJ	RC	MB	DG
P15	07/01/19	VERSION A	HJ	MB	MB	—
P16	07/01/19	P16	HJ	MB	MB	SW
C03	07/01/19	VERSION A	HJ	MB	MB	SW
P17	17/04/19	VERSION C	HJ	LP	RC	RC
P18	17/04/19	VERSION C	HJ	LP	RC	SW
C04	17/04/19	VERSION C	HJ	LP	RC	SW

Suitability	Drawing Status
A3	STAGE COMPLETED



Project Title <b>A30 CHIVERTON TO CARLAND CROSS</b>					
Drawing Title <b>WORKS PLANS APFP REGULATION 5(2)(J) SHEET 3 OF 8</b>					
Scale 1:2500	By HJ	Checked LP	Approved RC	Authorised SW	
Original Size A1	Date 17/04/19	Date 17/04/19	Date 17/04/19	Date 17/04/19	Date 17/04/19
Drawing Number HE PIN HA551502 - SW	Originator ARP	Volume LSI	-DR-ZL-000403		Revision C04
Location	Type	Role	Number		

DO NOT SCALE

Millimetres

0 10 100

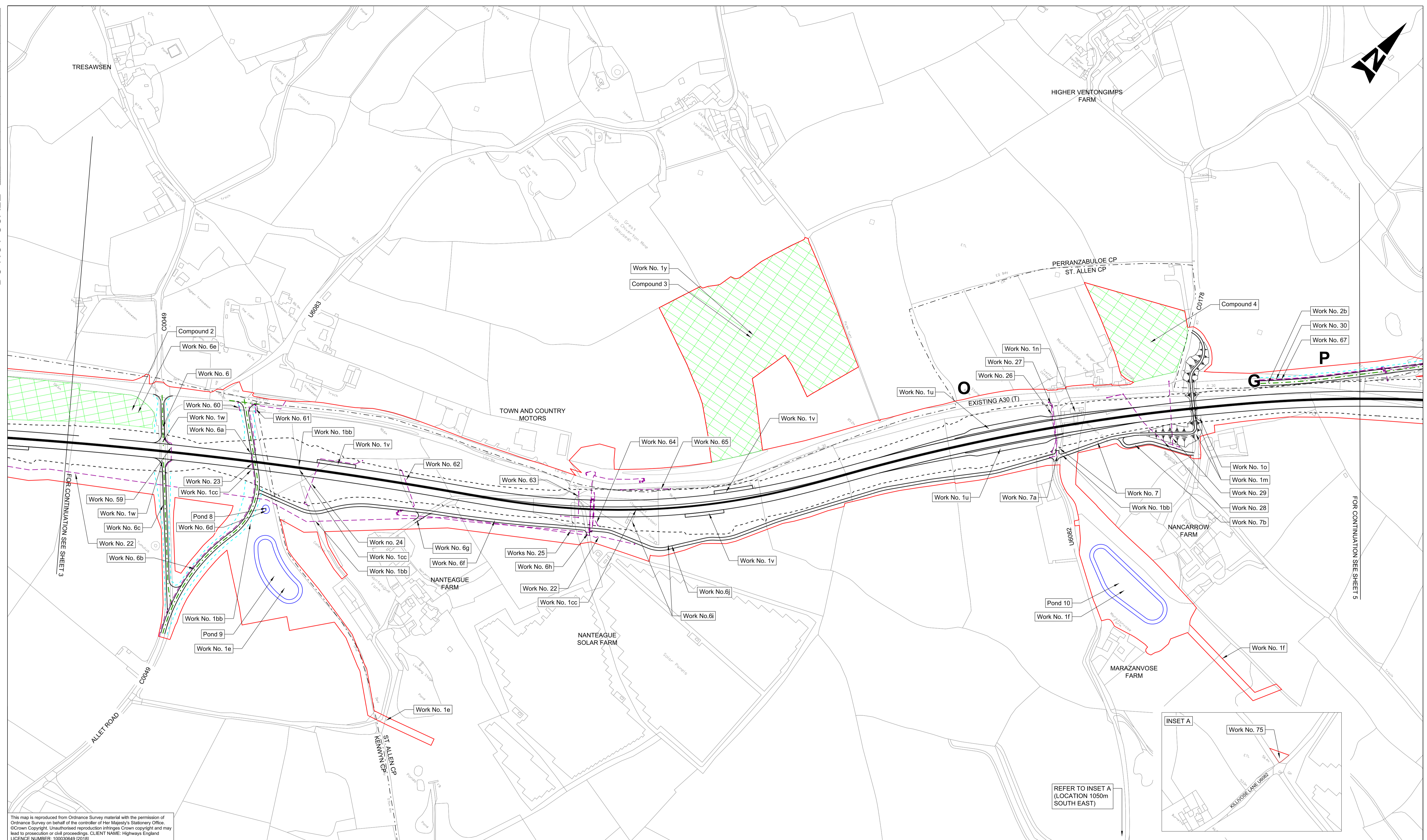

FOR CONTINUATION SEE SHEET 3

FOR CONTINUATION SEE SHEET 5

This map is reproduced from Ordnance Survey material with the permission of Ordnance Survey on behalf of the controller of Her Majesty's Stationery Office. © Crown Copyright. Unauthorised reproduction infringes Crown copyright and may lead to prosecution or civil proceedings. CLIENT NAME: Highways England LICENCE NUMBER: 100030649 (2018)

- GENERAL NOTES:**
- ALL DIMENSIONS ARE IN METRES UNLESS NOTED OTHERWISE.
  - ONLY WRITTEN DIMENSIONS SHALL BE USED, DO NOT SCALE.
  - THESE PLANS SHOULD BE READ IN CONJUNCTION WITH OTHER PLANS AND APPLICATION DOCUMENTS IN PARTICULAR SCHEDULE 3 OF THE DEVELOPMENT CONSENT ORDER.
- LEGEND:**
- DEVELOPMENT CONSENT ORDER BOUNDARY
  - A30 MAINLINE CENTRELINE
  - EXTENT OF CARRIAGEWAY (INCLUDING 0.5M LATERAL DEVIATION)
  - A30 MAINLINE EARTHWORKS (INCLUDING 1.75M LATERAL DEVIATION)
  - SIDE ROAD, JUNCTION AND SLIP ROAD CENTRELINE
  - SIDE ROAD EARTHWORKS (INCLUDING 1.75M LATERAL DEVIATION)
  - UTILITY DIVERSION WORK CENTRELINE
  - ATTENUATION POND BOUNDARY
  - PARISH BOUNDARY

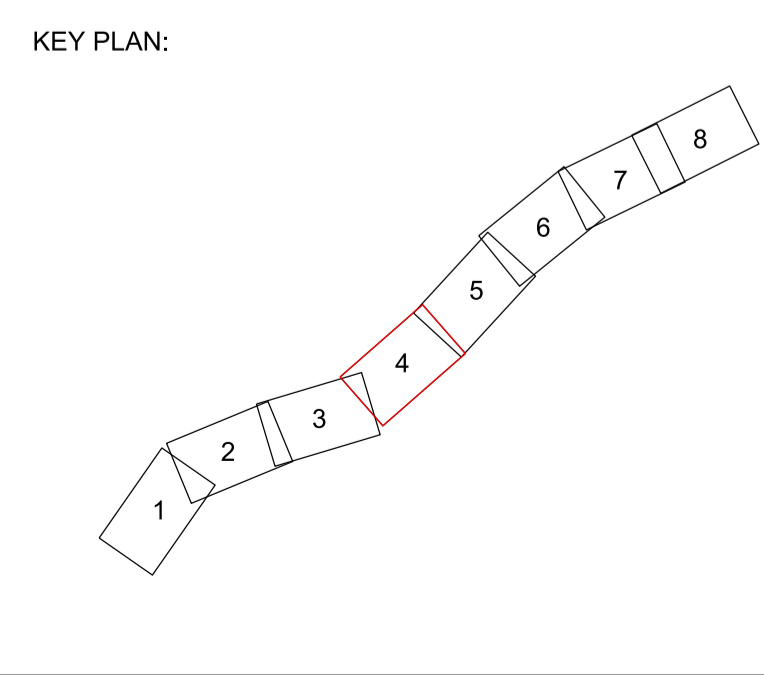
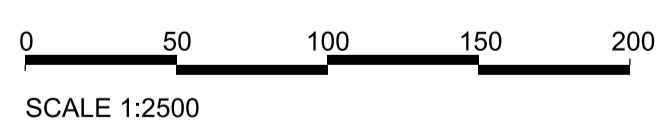

Rev.	Date	Description	By	Chk'd	App'd	Auth'd
C01	22/08/18	DCO ISSUE	LP	LP	RC	SW
P13	19/12/18	VERSION A	HJ	RC	MB	—
P14	19/12/18	VERSION A	HJ	RC	MB	DG
C02	19/12/18	VERSION A	HJ	RC	MB	DG
P15	15/03/19	VERSION B	HJ	LP	RC	—
P16	15/03/19	P16	HJ	LP	RC	SW
C03	15/03/19	VERSION B	HJ	LP	RC	SW
P17	17/04/19	VERSION C	HJ	LP	RC	RC
P18	17/04/19	VERSION C	HJ	LP	RC	SW
C04	17/04/19	VERSION C	HJ	LP	RC	SW

Suitability: **A3** Drawing Status: **STAGE COMPLETED**

Client:

Project Title: **A30 CHIVERTON TO CARLAND CROSS**

Drawing Title: **WORKS PLANS APFP REGULATION 5(2)(J) SHEET 4 OF 8**

Scale	By	Checked	Approved	Authorised
1:2500	HJ	LP	RC	SW

Original Size	Date	Date	Date	Date
A1	17/04/19	17/04/19	17/04/19	17/04/19

Drawing Number: **HA551502 - SW** Originator: **ARP** Volume: **LSI -DR - ZL -000404** Revision: **C04**

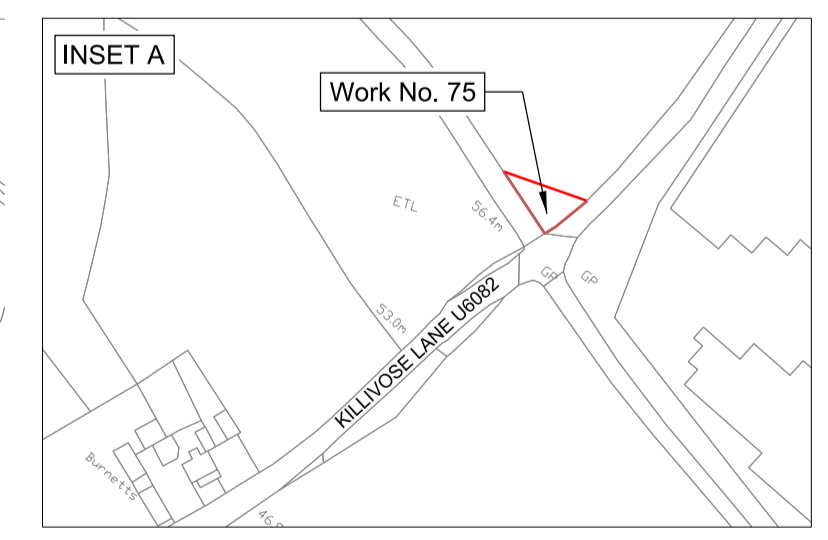





DO NOT SCALE

100  
0 10  
Millimetres

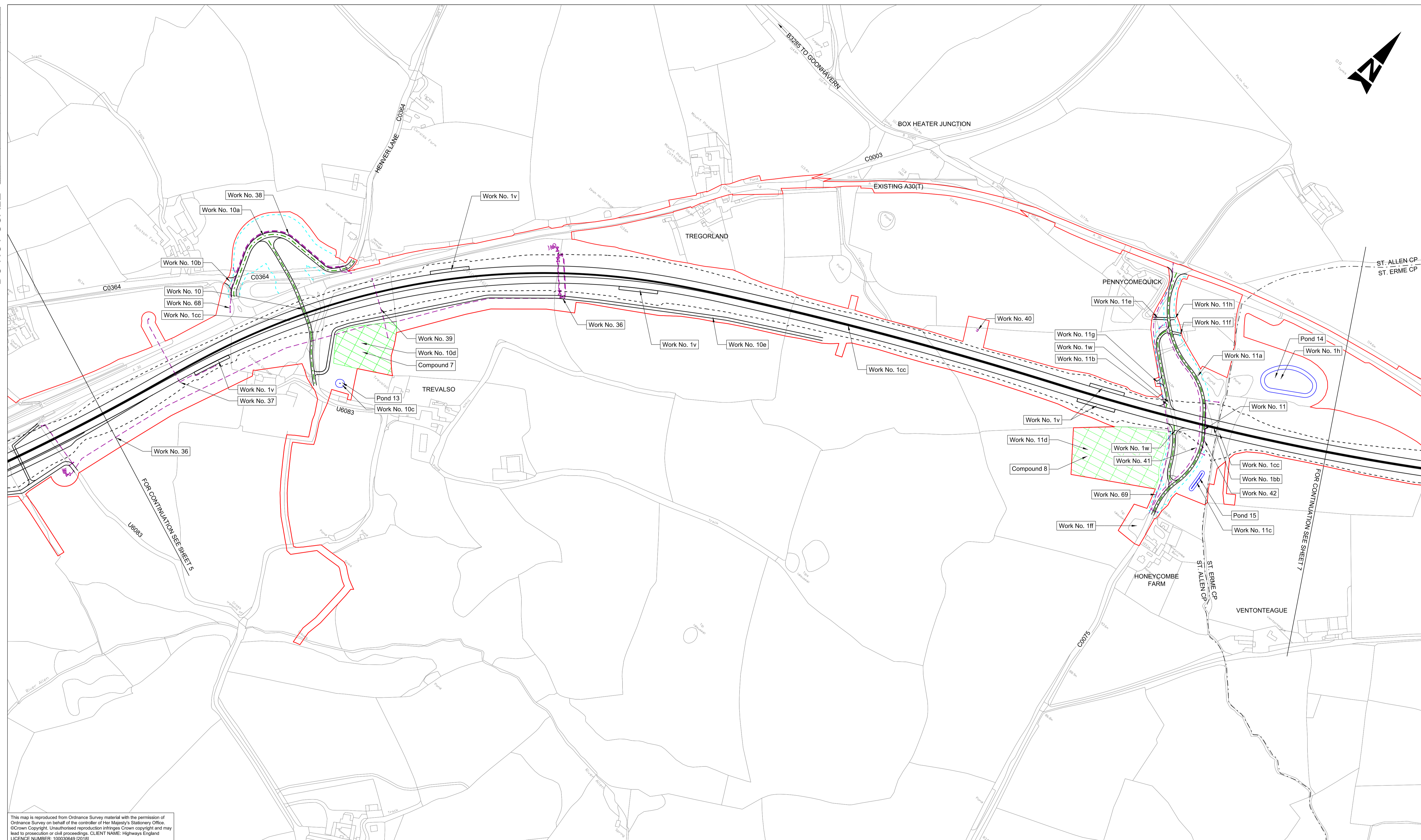
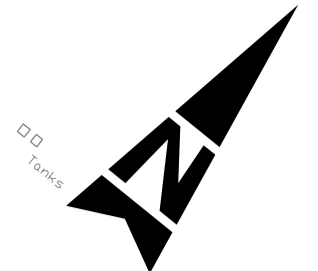

This map is reproduced from Ordnance Survey material with the permission of Ordnance Survey on behalf of the controller of Her Majesty's Stationery Office. © Crown Copyright. Unauthorised reproduction infringes Crown copyright and may lead to prosecution or civil proceedings. CLIENT NAME: Highways England LICENCE NUMBER: 100030649 (2018)

**GENERAL NOTES:**  
 1. ALL DIMENSIONS ARE IN METRES UNLESS NOTED OTHERWISE.  
 2. ONLY WRITTEN DIMENSIONS SHALL BE USED, DO NOT SCALE.  
 3. THESE PLANS SHOULD BE READ IN CONJUNCTION WITH OTHER PLANS AND APPLICATION DOCUMENTS IN PARTICULAR SCHEDULE 3 OF THE DEVELOPMENT CONSENT ORDER

**LEGEND:**  
 ——— DEVELOPMENT CONSENT ORDER BOUNDARY  
 ——— A30 MAINLINE CENTRELINE  
 ——— EXTENT OF CARRIAGEWAY (INCLUDING 0.5M LATERAL DEVIATION)  
 - - - - - A30 MAINLINE EARTHWORKS (INCLUDING 1.75M LATERAL DEVIATION)  
 - - - - - SIDE ROAD, JUNCTION AND SLIP ROAD CENTRELINE  
 - - - - - SIDE ROAD EARTHWORKS (INCLUDING 1.75M LATERAL DEVIATION)  
 - - - - - UTILITY DIVERSION WORK CENTRELINE  
 - - - - - ATTENUATION POND BOUNDARY  
 - - - - - PARISH BOUNDARY

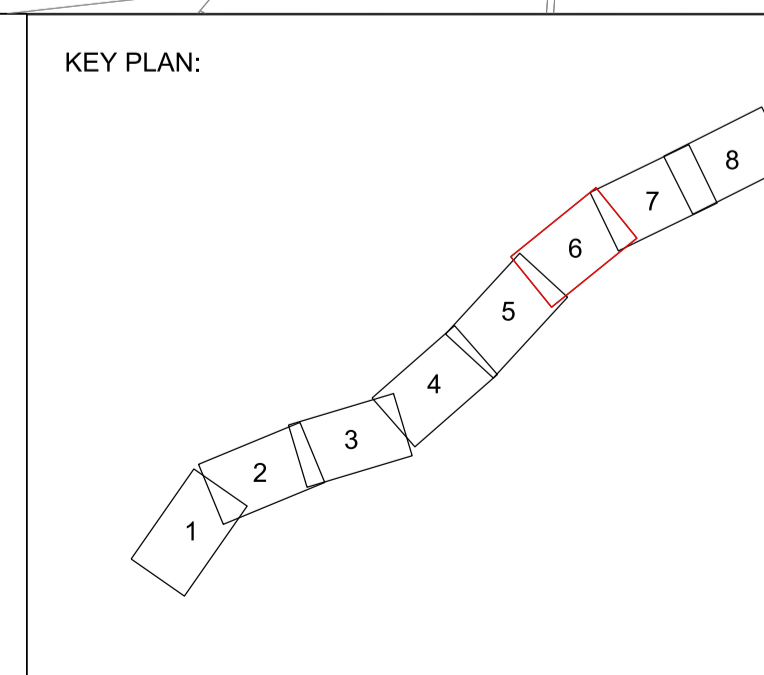
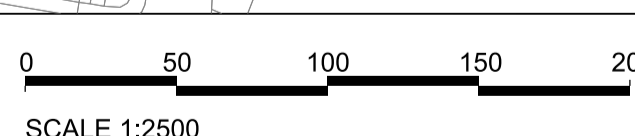

Rev.	Date	Description	By	Chk'd	App'd	Auth'd
C02	20/12/18	VERSION A	MB	MB	RC	DG
P17	07/01/19	VERSION A	HJ	MB	MB	—
P18	07/01/19	VERSION A	HJ	MB	MB	SW
C03	07/01/19	VERSION A	HJ	MB	MB	SW
P19	15/03/19	VERSION B	HJ	LP	RC	—
P20	15/03/19	P20	HJ	LP	RC	SW
C04	15/03/19	VERSION B	HJ	LP	RC	SW
P21	17/04/19	VERSION C	HJ	LP	RC	RC
P22	17/04/19	VERSION C	HJ	LP	RC	SW
C05	17/04/19	VERSION C	HJ	LP	RC	SW

Suitability	Drawing Status
A3	STAGE COMPLETED

Project Title <b>A30 CHIVERTON TO CARLAND CROSS</b>					
Drawing Title <b>WORKS PLANS APFP REGULATION 5(2)(J) SHEET 6 OF 8</b>					
Scale	By	Checked	Approved	Authorised	
1:2500	HJ	LP	RC	SW	
Original Size	Date	Date	Date	Date	Date
A1	17/04/19	17/04/19	17/04/19	17/04/19	17/04/19
Drawing Number	HE PIN	Originator	Volume	Revision	
HA551502 - SW	ARP	- DR - ZL	LSI -000406	C05	
Location	Type	Role	Number		



DO NOT SCALE

Millimetres

0 10 100

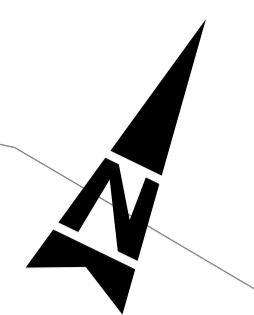
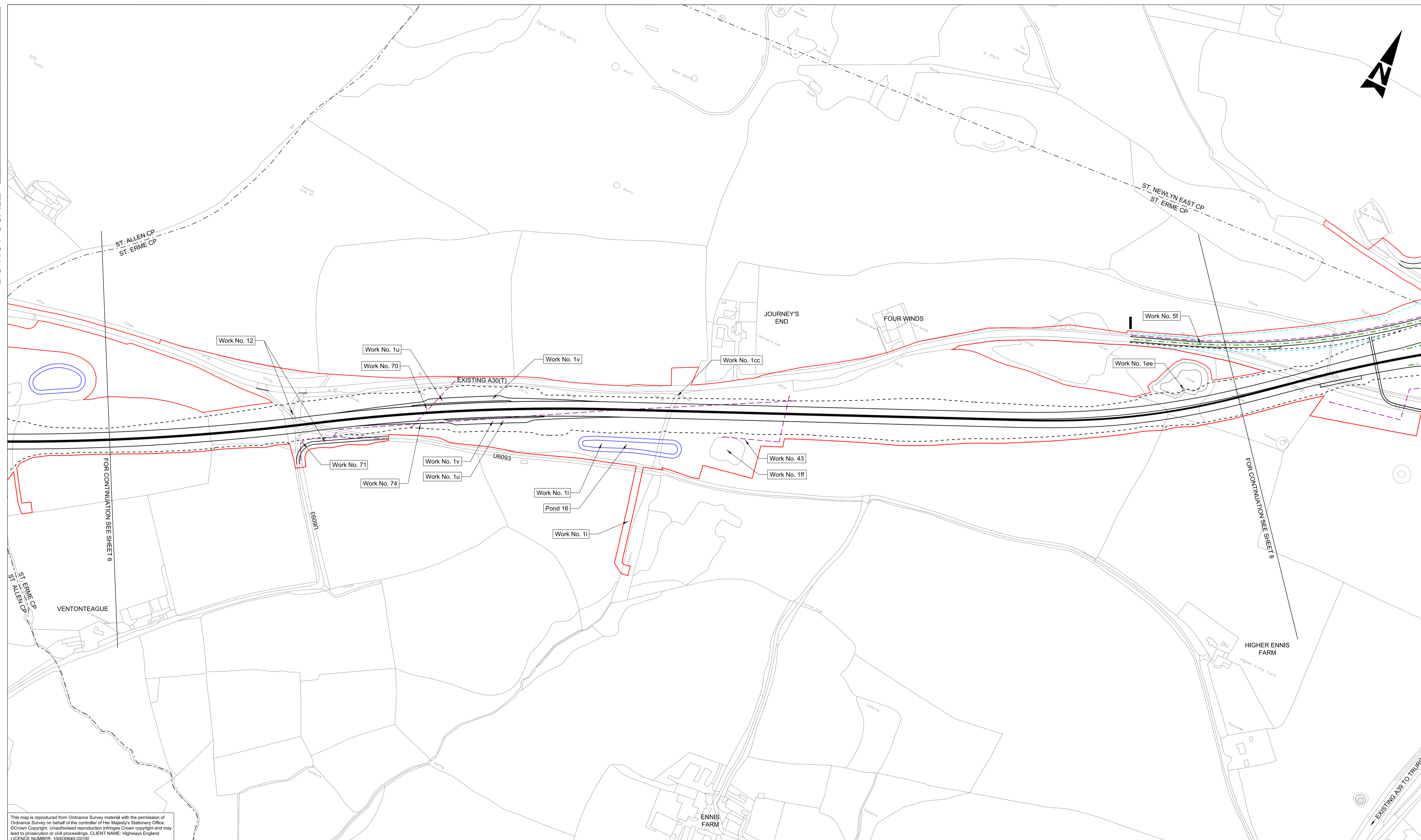

This map is reproduced from Ordnance Survey material with the permission of Ordnance Survey on behalf of the controller of Her Majesty's Stationery Office. © Crown Copyright. Unauthorised reproduction infringes Crown copyright and may lead to prosecution or civil proceedings. CLIENT NAME: Highways England LICENCE NUMBER: 100030649 (2018)

GENERAL NOTES:  
 1. ALL DIMENSIONS ARE IN METRES UNLESS NOTED OTHERWISE.  
 2. ONLY WRITTEN DIMENSIONS SHALL BE USED, DO NOT SCALE.  
 3. THESE PLANS SHOULD BE READ IN CONJUNCTION WITH OTHER PLANS AND APPLICATION DOCUMENTS IN PARTICULAR SCHEDULE 3 OF THE DEVELOPMENT CONSENT ORDER.

- LEGEND:
- DEVELOPMENT CONSENT ORDER BOUNDARY
  - DEMOLISHED OIL PIPE LINE
  - A30 MAINLINE CENTRELINE
  - EXTENT OF CARRIAGEWAY (INCLUDING 0.5M LATERAL DEVIATION)
  - - - A30 MAINLINE EARTHWORKS (INCLUDING 1.75M LATERAL DEVIATION)
  - - - SIDE ROAD, JUNCTION AND SLIP ROAD CENTRELINE
  - - - SIDE ROAD EARTHWORKS (INCLUDING 1.75M LATERAL DEVIATION)
  - - - UTILITY DIVERSION WORK CENTRELINE
  - ATTENUATION POND BOUNDARY
  - - - PARISH BOUNDARY

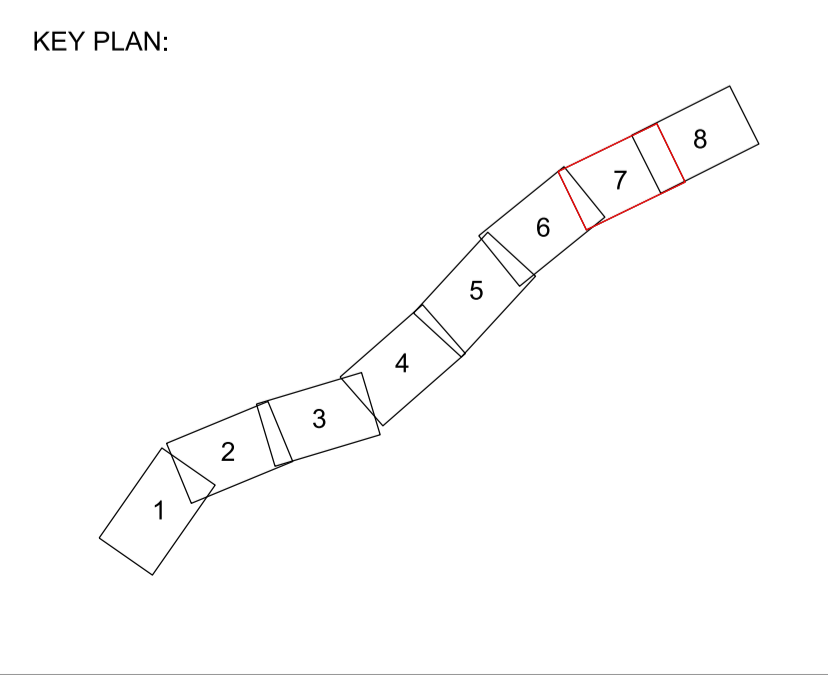
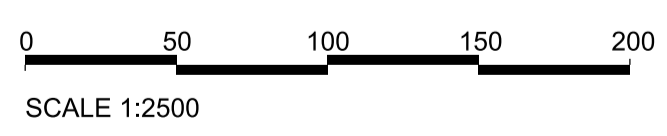

Rev.	Date	Description	By	Chk'd	App'd	Auth'd
C01	22/08/18	DCO ISSUE	LP	LP	RC	SW
P13	19/12/18	VERSION A	HJ	RC	MB	—
P14	19/12/18	VERSION A	HJ	RC	MB	DG
C02	19/12/18	VERSION A	HJ	RC	MB	DG
P15	07/01/19	VERSION A	HJ	MB	MB	—
P16	07/01/19	P16	HJ	MB	MB	SW
C03	07/01/19	VERSION A	HJ	MB	MB	SW
P17	17/04/19	VERSION C	HJ	LP	RC	RC
P18	17/04/19	VERSION C	HJ	LP	RC	SW
C04	17/04/19	VERSION C	HJ	LP	RC	SW

Suitability: **A3** Drawing Status: **STAGE COMPLETED**

Client:

Project Title: **A30 CHIVERTON TO CARLAND CROSS**

Drawing Title: **WORKS PLANS APFP REGULATION 5(2)(J) SHEET 7 OF 8**

Scale	By	Checked	Approved	Authorised
1:2500	HJ	LP	RC	SW

Original Size	Date	Date	Date	Date
A1	17/04/19	17/04/19	17/04/19	17/04/19

Drawing Number: **HA551502 - SW** | Originator: **ARP** | Volume: **LSI -DR - ZL -000407** | Revision: **C04**

DO NOT SCALE

Millimetres  
0 10 100

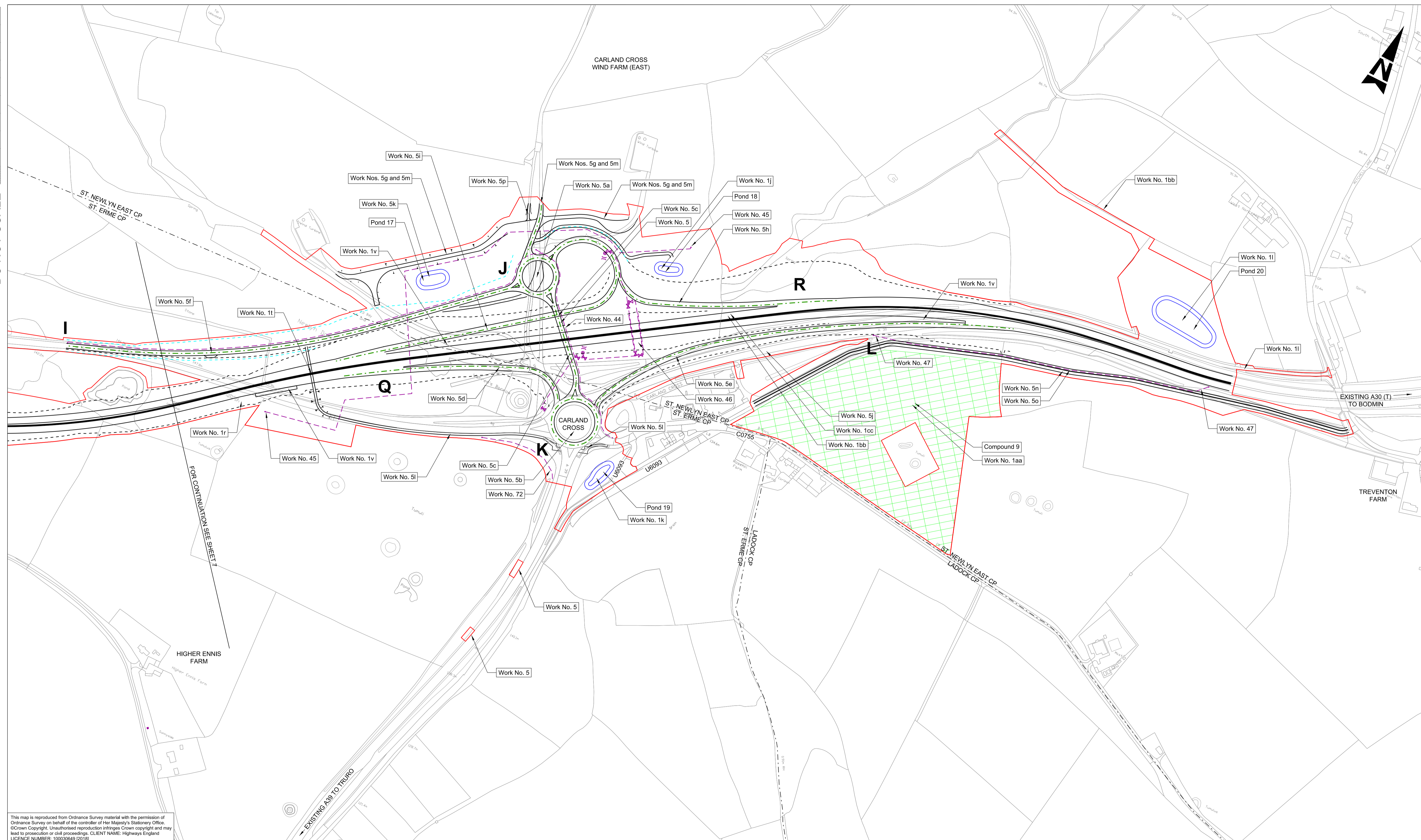

This map is reproduced from Ordnance Survey material with the permission of Ordnance Survey on behalf of the controller of Her Majesty's Stationery Office. © Crown Copyright. Unauthorised reproduction infringes Crown copyright and may lead to prosecution or civil proceedings. CLIENT NAME: Highways England LICENCE NUMBER: 100030649 (2018)

- GENERAL NOTES:
- ALL DIMENSIONS ARE IN METRES UNLESS NOTED OTHERWISE.
  - ONLY WRITTEN DIMENSIONS SHALL BE USED, DO NOT SCALE.
  - THESE PLANS SHOULD BE READ IN CONJUNCTION WITH OTHER PLANS AND APPLICATION DOCUMENTS IN PARTICULAR SCHEDULE 3 OF THE DEVELOPMENT CONSENT ORDER

- LEGEND:
- DEVELOPMENT CONSENT ORDER BOUNDARY
  - A30 MAINLINE CENTRELINE
  - EXTENT OF CARRIAGEWAY (INCLUDING 0.5M LATERAL DEVIATION)
  - A30 MAINLINE EARTHWORKS (INCLUDING 1.75M LATERAL DEVIATION)
  - SIDE ROAD, JUNCTION AND SLIP ROAD CENTRELINE
  - SIDE ROAD EARTHWORKS (INCLUDING 1.75M LATERAL DEVIATION)
  - UTILITY DIVERSION WORK CENTRELINE
  - ATTENUATION POND BOUNDARY
  - PARISH BOUNDARY

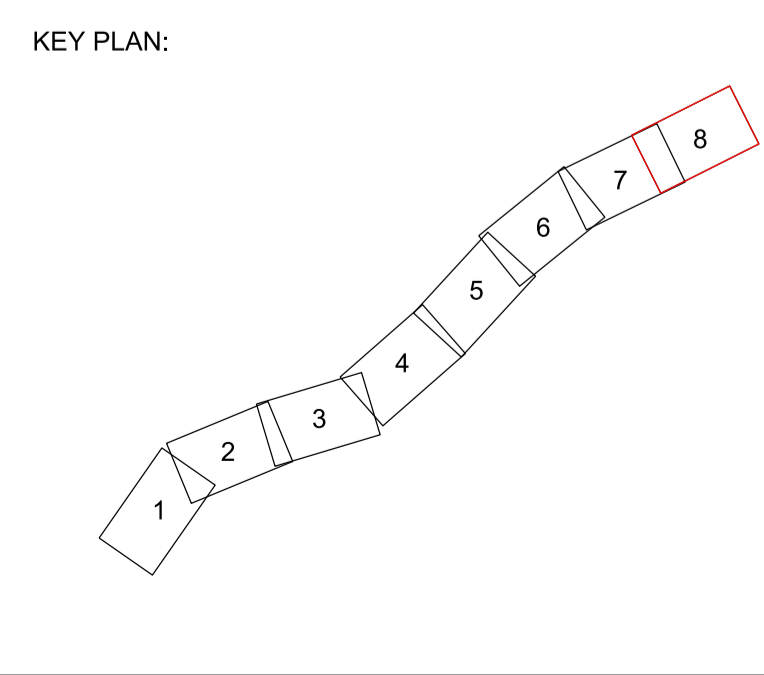
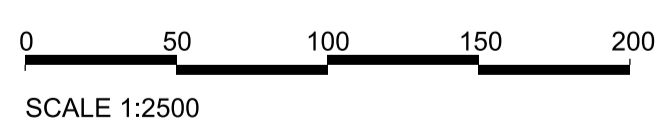

Rev.	Date	Description	By	Chk'd	App'd	Auth'd
C02	20/12/18	VERSION A	MB	MB	RC	DG
P17	07/01/19	VERSION A	HJ	MB	MB	—
P18	07/01/19	VERSION A	HJ	MB	MB	SW
C03	07/01/19	VERSION A	HJ	MB	MB	SW
P19	15/03/19	VERSION B	HJ	LP	RC	—
P20	15/03/19	P20	HJ	LP	RC	SW
C04	15/03/19	VERSION B	HJ	LP	RC	SW
P21	17/04/19	VERSION C	HJ	LP	RC	RC
P22	17/04/19	VERSION C	HJ	LP	RC	SW
C05	17/04/19	VERSION C	HJ	LP	RC	SW

Suitability	A3	Drawing Status	STAGE COMPLETED
Client			

Project Title					
A30 CHIVERTON TO CARLAND CROSS					
Drawing Title					
WORKS PLANS APFP REGULATION 5(2)(J) SHEET 8 OF 8					
Scale	1:2500	By	HJ	Checked	LP
Original Size	A1	Date	17/04/19	Date	17/04/19
Approved	RC	Authorised	SW	Date	17/04/19
Drawing Number	HA551502 - SW	Originator	ARP	Volume	LSI
Location	SW	Type	-DR - ZL	Role	-000408
Revision	C05	Number			



If you need help accessing this or any other Highways England information,  
please call **0300 123 5000** and we will help you.